

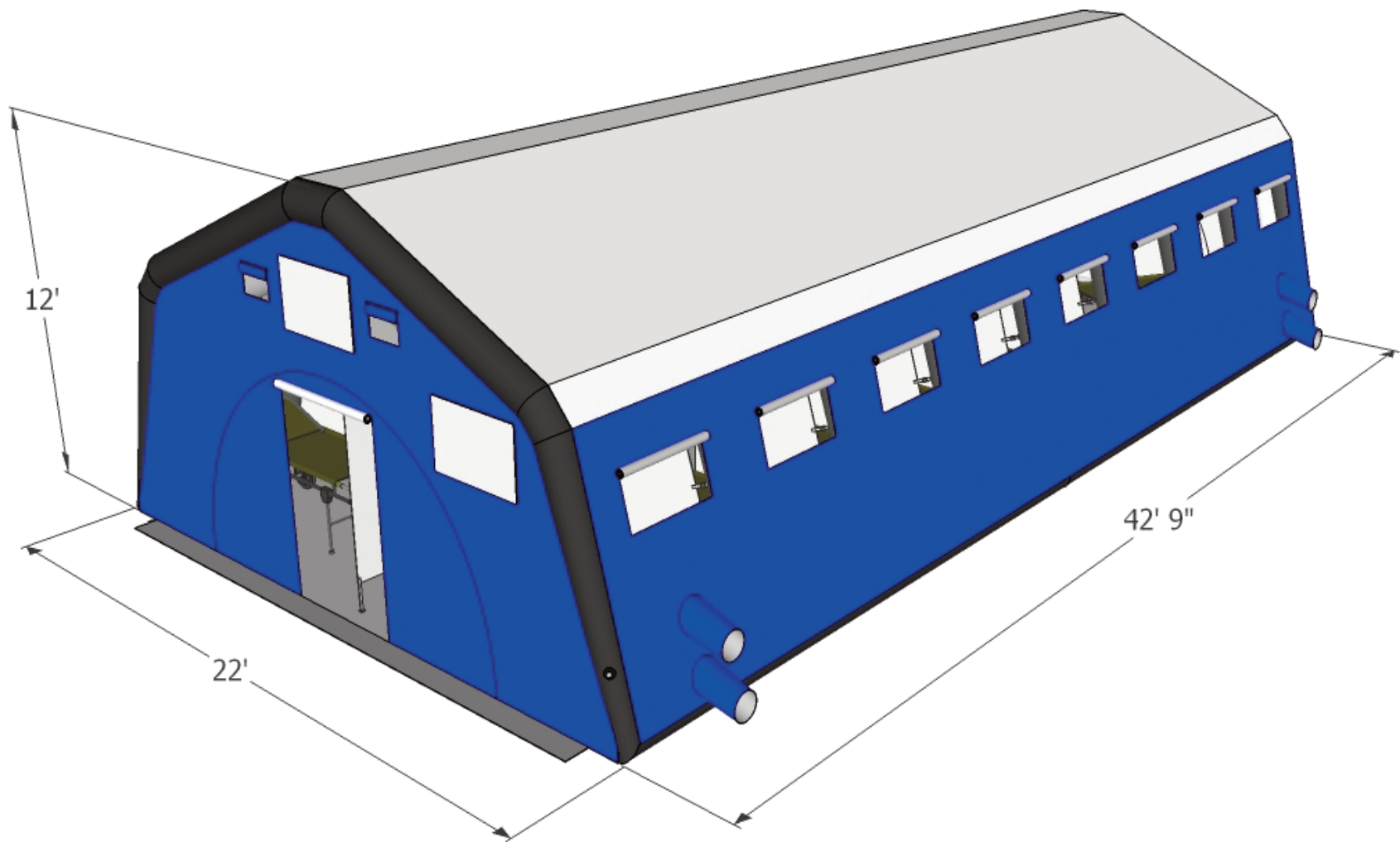

www.charlieshorse.com

email: charlie@charlieshorse.com



12'

22'

42' 9"

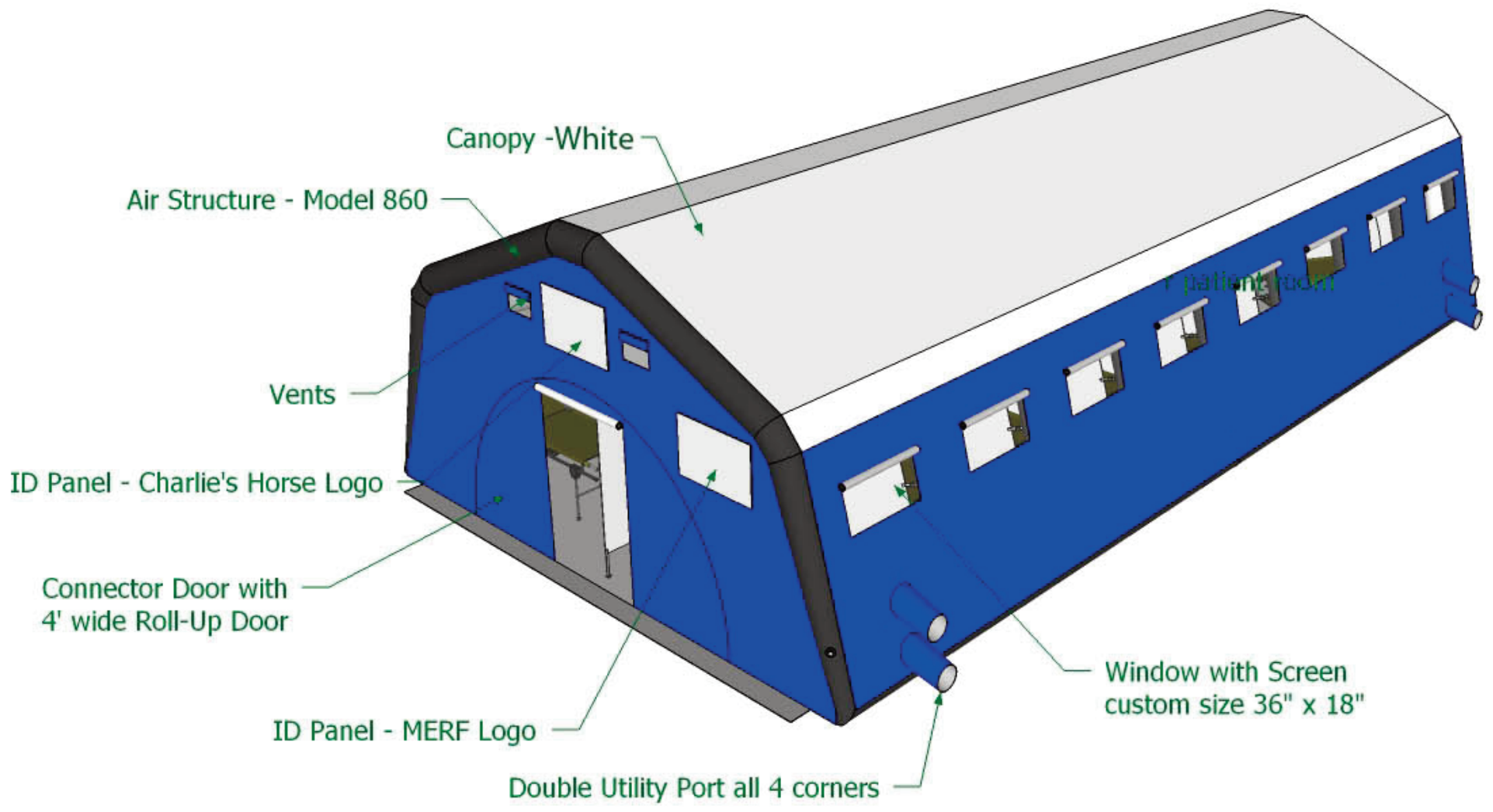

Canopy -White

Air Structure - Model 860

patient room

Vents

ID Panel - Charlie's Horse Logo

Connector Door with
4' wide Roll-Up Door

ID Panel - MERF Logo

Double Utility Port all 4 corners

Window with Screen
custom size 36" x 18"

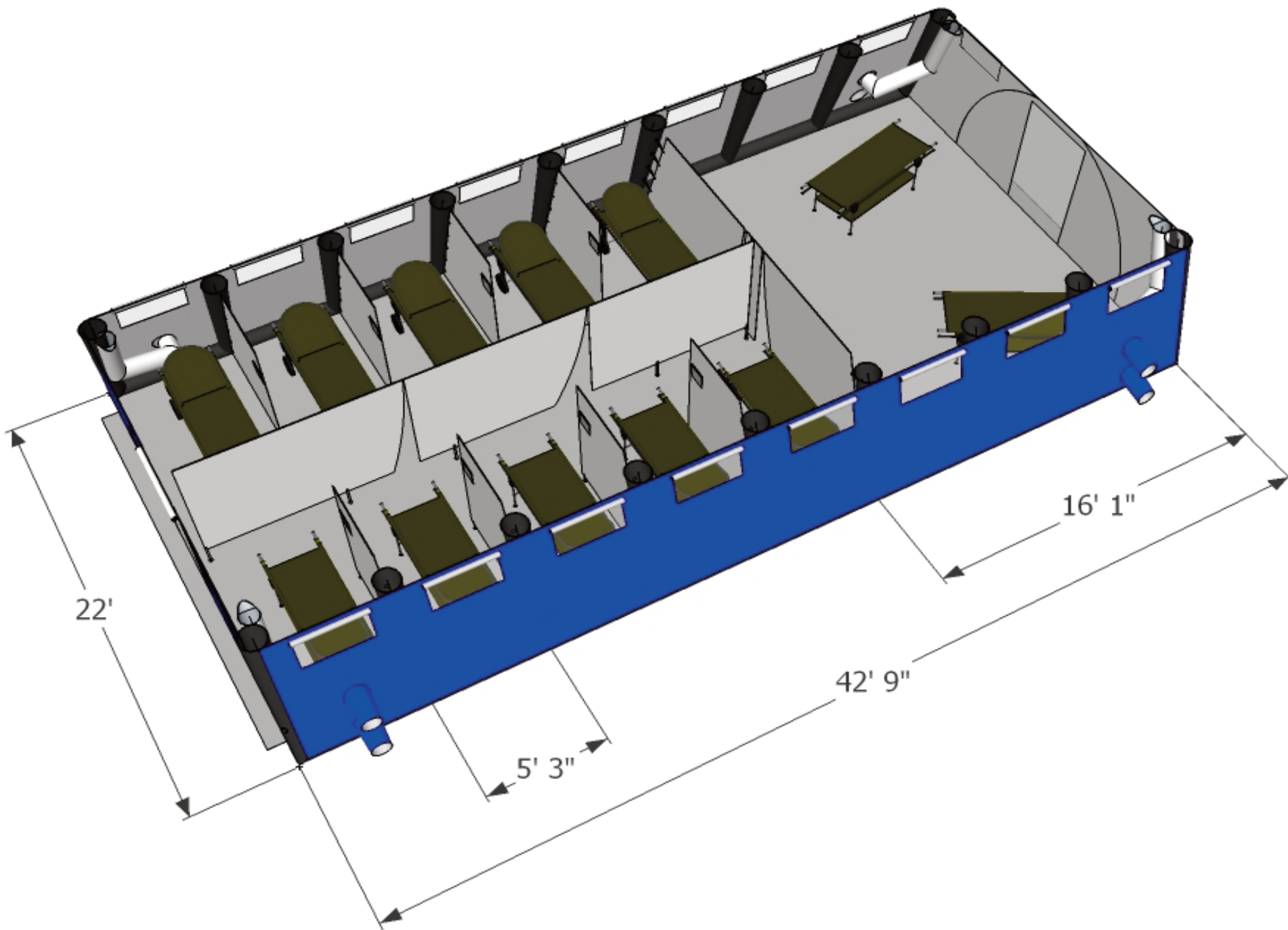

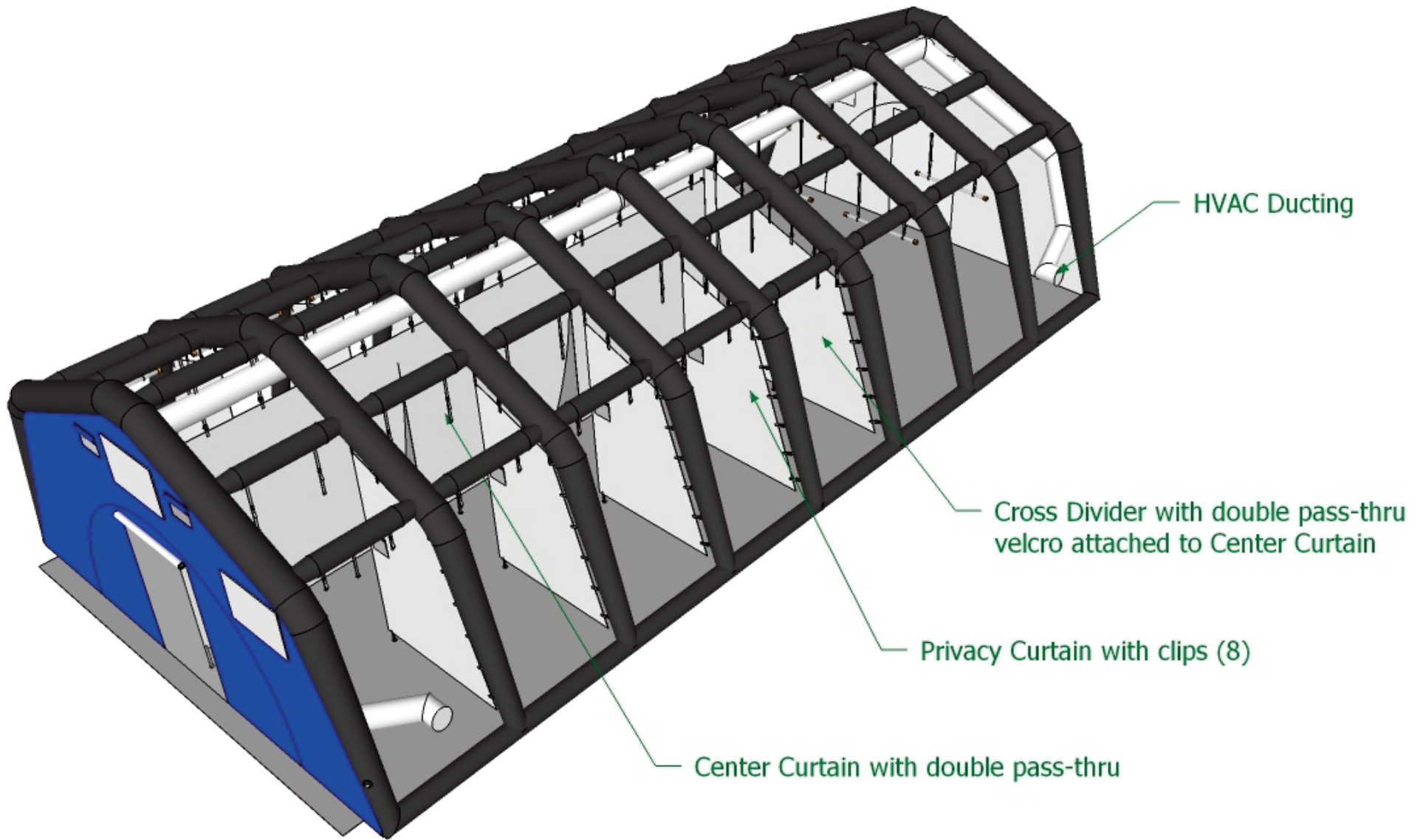

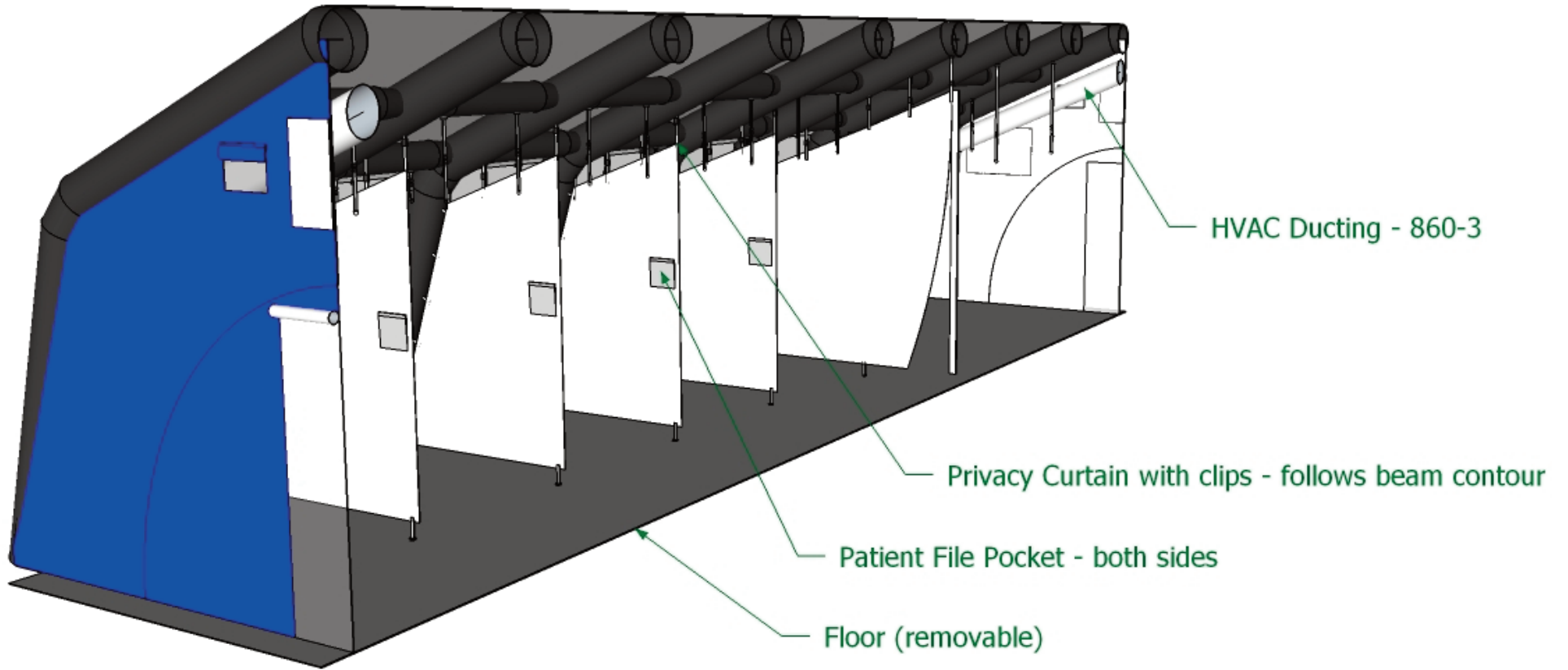

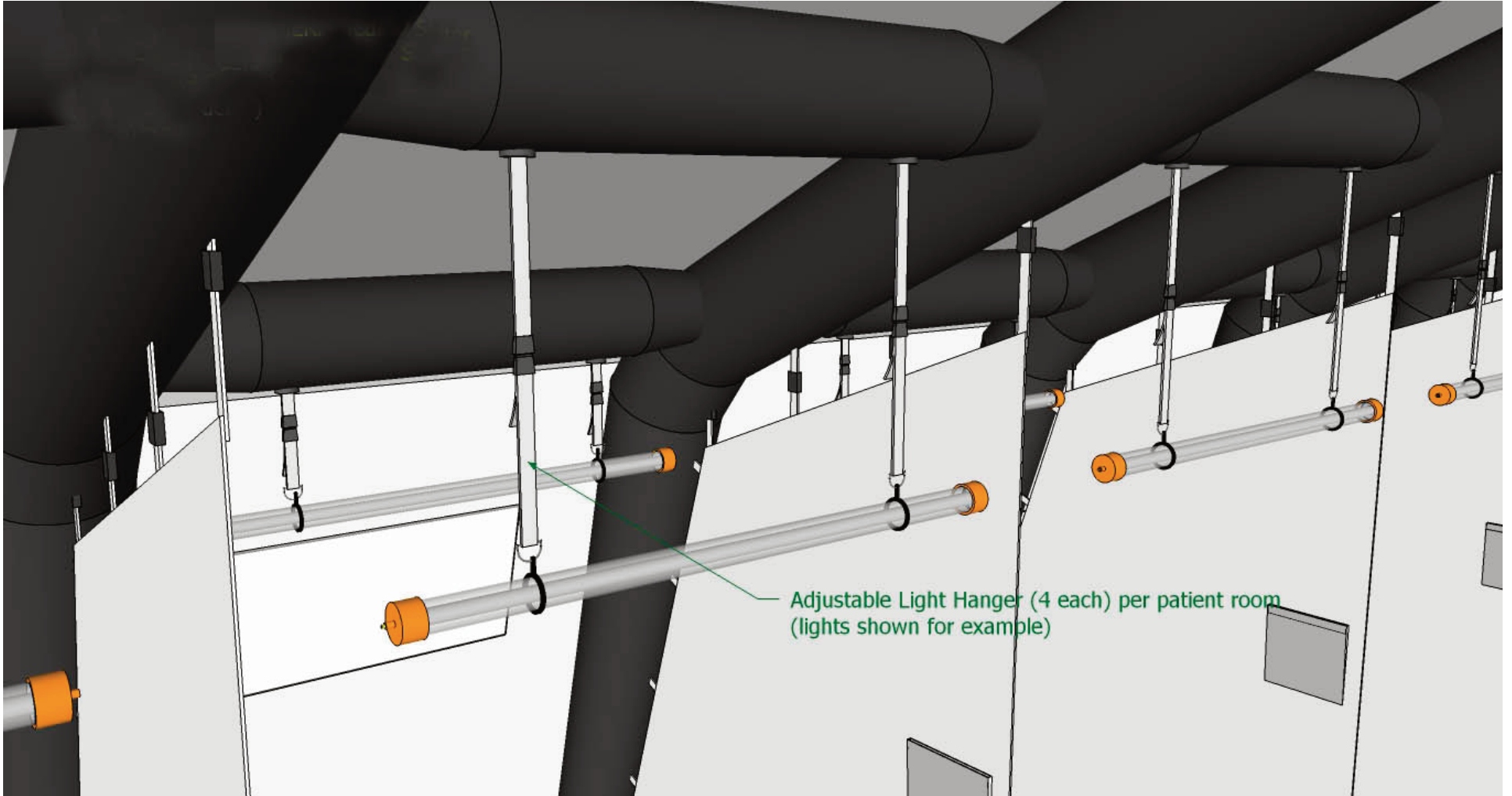

Adjustable Light Hanger (4 each) per patient room
(lights shown for example)

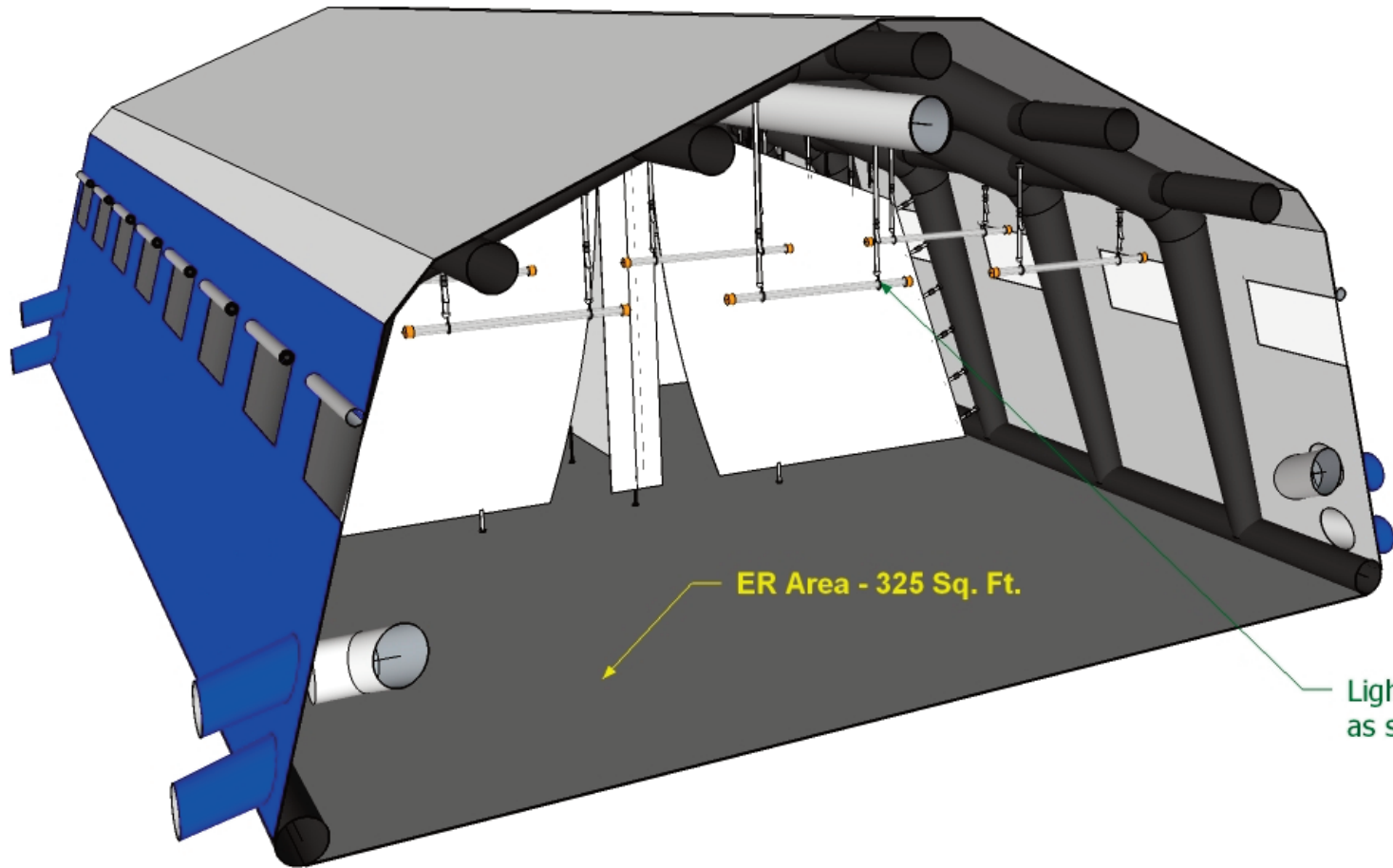

ER Area - 325 Sq. Ft.

Light Hangers for 3 lights positioned as shown both arch-beams

